

### 086 Lever handle for ball valves and bibcocks



Mention "N" in the code to order the black handle.  
Mention "B" in the code to order the blue handle.

Size of the handle corresponding to each valve.

Art.	1/4"	3/8"	1/2"	3/4"	1"	1 1/4"	1 1/2"	2"	2 1/2"	3"	4"
111/112	1	1	1	2	3	3	4	4	6	7	7
090/091	1	1	1	3	3	4	4	5	6	7	7
116/117	1	1	1	3	3	4	4	5	6	7	7
070/071G	-	-	2	3	3	4	5	5	7	7	7
080/081	-	-	2	3	3	4	5	5	7	7	7
131/132	-	1	1	2	2	-	-	-	-	-	-
166/168	-	-	1	1	-	-	-	-	-	-	-
170/174	-	-	1	1	-	-	-	-	-	-	-
178/179	-	-	1	1	-	-	-	-	-	-	-
066/067G	1	1	2	3	3	4	5	5	7	7	7
076/077	1	1	2	3	3	4	5	5	7	7	7
115	-	-	1	3	3	4	4	5	-	-	-
098	-	-	-	-	-	-	4	5	-	-	-

SIZE	CODE	PACKING
1	0860001/N/B	20/1000
2	0860002/N/B	20/800
3	0860003/N/B	20/500
4	0860004/N/B	10/300
5	0860005/N/B	10/200
6	0860006/N	1/90
7	0860007/N	1/45



### 084 Flat lever handle for ball valves



Mention "V" in the code to order the green handle.

SIZE	CODE	PACKING
1	0840001/V	20/800
2	0840002/V	20/600
3	0840003/V	20/400
4	0840004/V	10/250
5	0840005/V	10/170

### 089B Stainless steel flat lever handle for ball valves

NEW 2020



Made of AISI 304 stainless steel.

Size of the handle corresponding to each valve.

Art.	1/4"	3/8"	1/2"	3/4"	1"	1 1/4"	1 1/2"	2"
111/113	1	1	1	2	3	3	4	4
211	1	1	1	2	3	3	4	4
090/091/290/290P/291P	1	1	1	3	3	4	4	5
116/117	1	1	1	3	3	4	4	5
216/217	1	1	1	3	3	4	4	5
070/071G	-	-	2	3	3	4	5	5
080/081	-	-	2	3	3	4	5	5
133	-	1	1	2	2	-	-	-
166/168	-	-	1	1	-	-	-	-
170/174	-	-	1	1	-	-	-	-
178/179	-	-	1	1	-	-	-	-
066/067G	1	1	2	3	3	4	5	5
076/077	1	1	2	3	3	4	5	5
376/377	1	1	2	3	3	4	5	5
115	-	-	1	3	3	4	4	5
145	1	1	1	3	3	4	4	5

### INFO

This device has to be used on valves and biblocks with flat lever handle.  
Size of the handle corresponding to each valve as in art. 084 grey background chart.

Zincplated K5 zamak.  
The device is supplied without padlock.  
Suitable padlock with long shackle: 6mm / 1/4.

### 084LK Locking device for lockable flat lever handle



SIZE	CODE	PACKING
1	084LK01	10/500
2	084LK02	10/500
3	084LK03	10/500

### 084PP Pin for locking device



CODE	PACKING
084PP03	-

### INSTALLATION OF THE LOCKING DEVICE FOR LOCKABLE FLAT LEVER HANDLE

When the valve is not equipped with a flat lever handle, it is possible to replace the standard handle as shown in this catalogue, in order to have a lockable valve.

1. Remove the handle from the valve, when you want to have a lockable valve.

2. Replace the handle with the corresponding flat lever handle, in order to have a lockable valve.

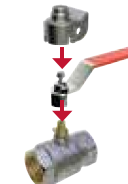

3. Place and lock the locking device either on the open or on the shut-off valve.

4. 084PP - Pin for locking device. Usable on water or gas valves.



### 087 T handle for ball valves and bibcocks



Mention "N" in the code to order the black handle.  
Mention "V" in the code to order the green handle.  
Mention "B" in the code to order the blue handle.

SIZE	CODE	PACKING
1	0870001/N/V/B	20/2000
2	0870002/N/V/B	20/1500
3	0870003/N/V/B	20/1200
4	0870004/N/B	10/800

Size of the handle corresponding to each valve.

Art.	1/4"	3/8"	1/2"	3/4"	1"	1 1/4"
113/114	1	1	1	2	2	-
092/093/292P/293P	1	1	1	3	3	4
118/119	1	1	1	2	3	-
072/073G	-	-	2	3	3	-
082/083	-	-	2	3	3	-
134	-	1	1	2	3	-
172/176	-	-	1	1	-	-
180	-	-	1	1	-	-
068/069G	1	1	2	3	3	-
078/079	1	1	2	3	3	-
378/379	1	1	2	3	3	-
098	-	-	1	3	3	4
298	-	-	1	3	3	-