

# Industrial Quick Connect Couplings

## single shut-off Serie ESOIG

- High-quality, extreme robust quick connect couplings made of brass MS 58 plain (on demand nickel-plated) with superior seal characteristics
- Interchangeable with ARO 310, ORION 44520
- High flow rate at a low pressure drop due to streamlined valve
- For the supply of compressed air or other fluid or gaseous media in industry and craftsmanship

### Materials

- Body, valve body, valve, sleeve: Brass MS 58 plain
- O-rings: Buna N (other materials on request)
- Springs, retaining ring: Stainless steel 1.4310
- Pins: Stainless steel 1.4305
- Plug: Hardened steel and nickel-plated

**DN 9**

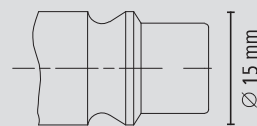

Plug Profile (original size)

Max. Work. Pressure	Temperature	DN	Thread	Flow Capacity	Operation	Type of valve	Media	Area	
PN 35 bar	-20°C – +100°C	9	ISO 228 / DIN 2999	1400 l/min	One-Hand	Single Shut-Off	Druckluft	BeNeLux, CH,	10

### Couplings with female thread

Thread connection	L	SW	D	L1	Weight	Type No.
G 3/8 f	46	27	32	10	164	ESOIG 38 I
G 1/2 f	46	27	32	11	155	ESOIG 12 I

### Plugs with tapered male thread

Thread connection	L	SW	L1	L2	Weight	Type No.
R 3/8 m	40	17	12	23	40	ESOIG 38 NAS
R 1/2 m	46	22	17	23	54	ESOIG 12 NAS

### Plugs with parallel female thread

Thread connection	L	SW	L1	L2	Weight	Type No.
G 3/8 f	35	19	9	23	28	ESOIG 38 NIS
G 1/2 f	39	24	12	23	48	ESOIG 12 NIS

### Plugs with hose barb

Hose connection	L	D	L1	L2	Weight	Type No.
Hose i.D. 10	51	16	25	23	25	ESOIG 10 SS
Hose i.D. 13	51	16	25	23	33	ESOIG 13 SS
Hose i.D. 19	51	19	25	23	44	ESOIG 19 SS

For hose clips type ZOS (© page 314), type HS (© page 315) or crimping ferrules type LPH (© page 318)

