

Solenoid & Pilot Actuated Spool Valves

Port Thread 1/2

5Port 2Position Solenoid Valve

Single Solenoid
SF6101-IP-SD2-*

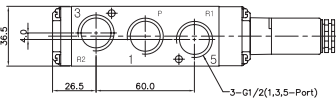
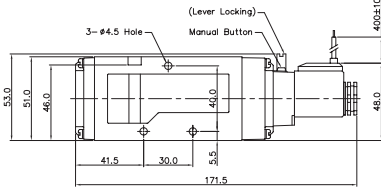
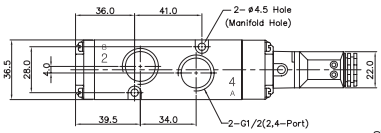
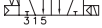

Double Solenoid
SF6200-IP-SC2-CN2-*

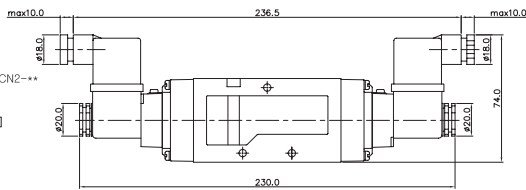

5Port 3Position Solenoid Valve

Closed Center

SF6303-IP-SC2-CN2-*

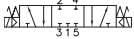

Exhaust Center

SF6403-IP-SC2-CN2-*

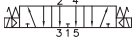

Pressure Center

SF6503-IP-SC2-CN2-*

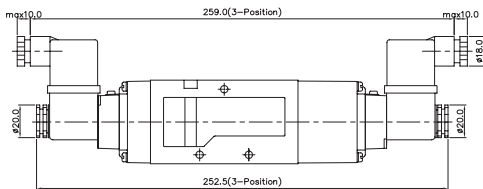
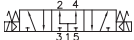

5Port 2Position Pneumatic Valve

Single Pneumatic

SFP6101

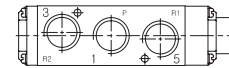
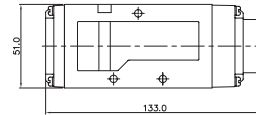
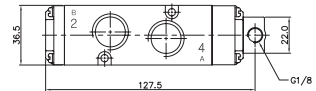

Double Pneumatic

SFP6200

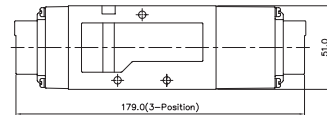
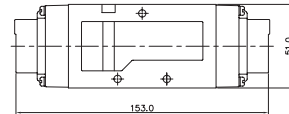
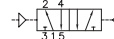

5Port 3Position Pneumatic Valve

Closed Center

SFP6303

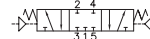

Exhaust Center

SFP6403

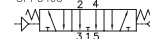

Pressure Center

SFP6503

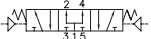

Manifold Block Ordering Code

MF 6500		-		2	
Series	Manifold Station				
MF6500	5 Way	02	2-Station		
		04	4-Station		
		06	6-Station		
		08	8-Station		
		10	10-Station		

Blanking Plate Ordering Code

MF6500-BLK

Blanking Plate.
(Material: SCP1)

Gasket O-Ring
(Material: NBR)

MF6000 MANIFOLD BLOCK

(SF6000 Solenoid & Pneumatic Valve Use)

5-Port Manifold Block

MF6500-4

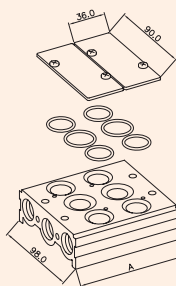

MF6500-BLK
Blanking Plate
Gasket O-Ring

MF6500-02
Manifold Block

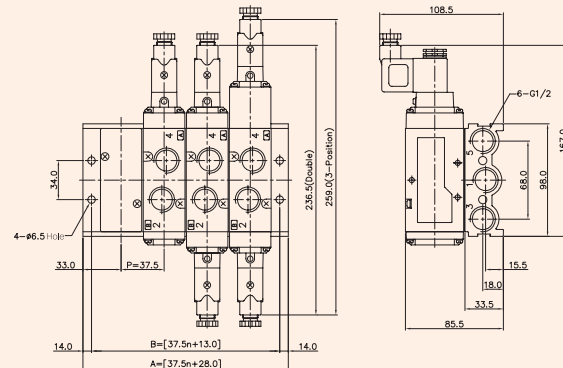
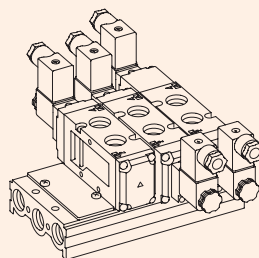

5PORT MANIFOLD BLOCK DIMENSION		n=STATION				
ITEM	1	2	4	6	8	10
B	88.0	163.0	238.0	313.0	388.0	
A	103.0	178.0	253.0	328.0	403.0	