

**CABLE REEL FOR
 SIGNAL TRANSMISSION**
 DataFlux

ART. 142405

Length (m)
17

Number of conductors
24 x 0,5

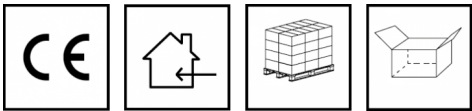

TECHNICAL DATA

| Article | Structure | Number of conductors | Cable length (m) | Reel cable length (m) | Cut length (m) | Cable diameter (mm) | Cable type | Cable composition | IGUS Code | Winder protection grade |
|---------|-----------|----------------------|------------------|-----------------------|----------------|---------------------|------------|-------------------|-----------|-------------------------|
| 142405 | Aluminium | 24 x 0,5 | 17 | 15 | 2 | 13 | TPE | 24 x 0,5 | CF9.05.25 | IP65 |

Please note: The images are for illustrative and explanatory purposes only

OVERALL DIMENSIONS

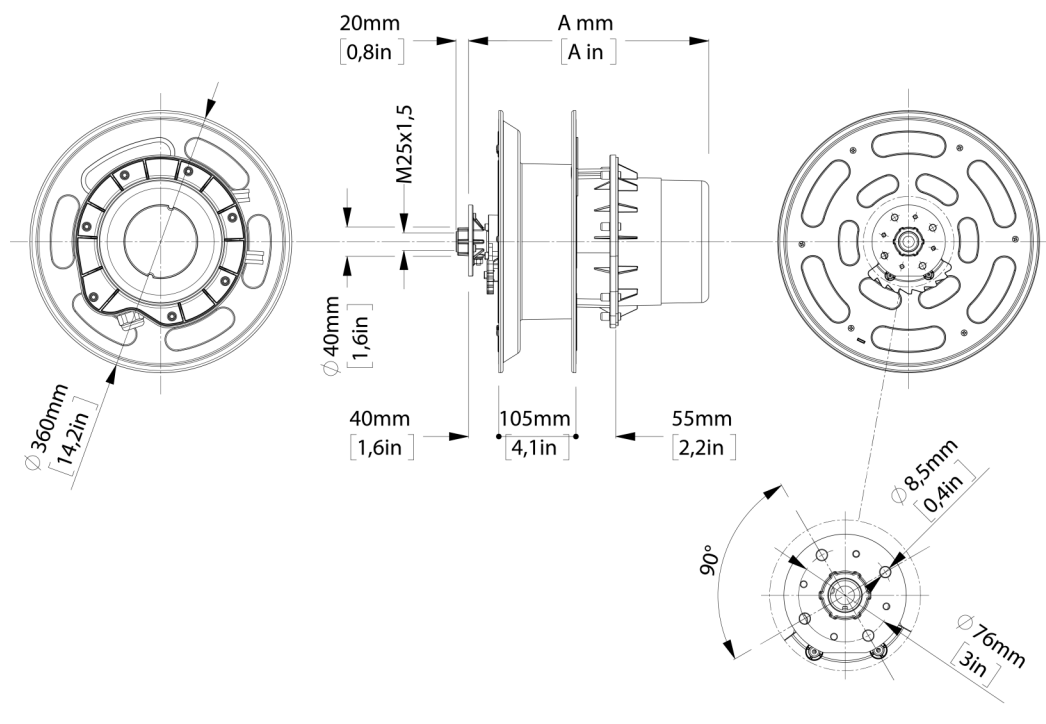

Collector technical characteristics

- 6/12/24 slopes, Maximum range 2A, Max 48V.
- Gold alloy rings and brushes.
- Very high reliability and durability.
- Very low friction torque.
- Dielectric strength: 500 Vac at 60 Hz.
- Insulation resistance: $\rightarrow 1000 \text{ M}\Omega / 500 \text{ Vcc}$.
- Noise:

Technical characteristics cable

- External coating: particularly flexible PUR / TPE compound resistant to abrasion, oil and coolants.
- Silicone-free.
- Halogen free (conforming to EN 50267-2-1).
- Lead free (compliant with 2011/65 / EU ROHS-II)
- Conductors grouped in bundles, stranded with short pitch, optimized for excellent torsion resistance.
- Suitable for mobile laying (reduced radius of curvature).